



BER investments in computing facilities

5/11/2020

Lee Ann McCue
EMSL Deputy of Computing



PNNL is operated by Battelle for the U.S. Department of Energy



EMSL Computing Facility

- Experienced systems administrators, computing operations staff
- Currently houses EMSL's Cascade system, slated for retirement
- Installation of EMSL's Tahoma system, June 2020
- Plans to house a system for the ESS Coastal research program
 - heterogeneous, high-performance midrange computing system
 - software stack for the diverse code base needed for modeling hydrology and geochemistry processes in watersheds, atmospheric and earth system processes

> 8500 ft² raised floor space

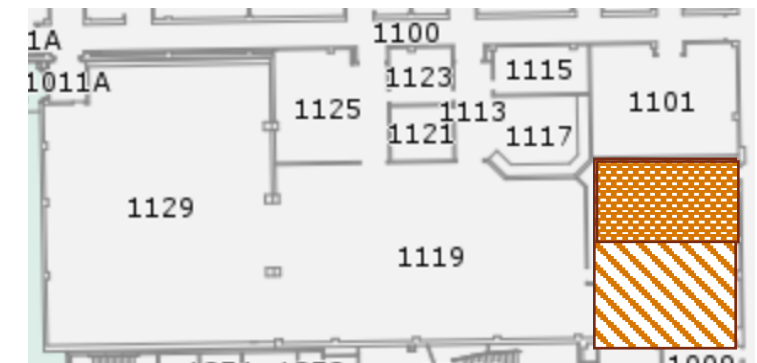

BER compute resource planning

- Access and eligibility
 - open to DOE BER funded research projects
 - requests reviewed and approved by BER program managers
 - available semi-annually for large allocations
 - available continually for small allocations
- Usage and queues
 - target < 80% utilization
 - reserved nodes for interactive use
- Data transfer
 - ESNNet upgrade to 100Gbps, and 400 Gbps when available
 - Globus on DTNs
- Support
 - Distributed support for science applications